

BB 1068/BB 1099 SERIES

HEAVY DUTY BALL BEARING TEMPLATE HINGES

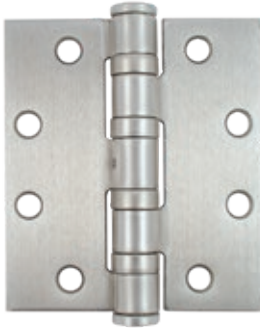

- Heavy weight, full mortise
- 5 knuckles, 4 ball bearings
- Steel or stainless steel hinge and pin
- Conforms to ANSI/BHMA A156.1
- ANSI/BHMA A156.7 template hole pattern

- Non-handed
- Flat tips with knock-out bottom
- Wood screws and undercut machine screws included

MODELS

BB1068: Steel hinge and pin

BB1099: Stainless steel hinge and pin

OPTIONS

N: Non-removable pin (NRP)

BB1068	-	4545	-	26D	-	N
MODEL	SIZE	FINISH	OPTION			

SIZE	INCHES	MM	GAUGE	HOLES	SCREWS INCLUDED		QTY ¹
					MACHINE	WOOD	
4545	4½ x 4½	114.3 x 114.3	0.180	8	#12-24 x ½	#12 x 1¼	3/48
545	5 x 4½	127 x 114.3	0.190	8	#12-24 x ½	#12 x 1¼	3/48
55	5 x 5	127 x 127	0.190	8	#12-24 x ½	#12 x 1¼	3/48

(1) 3/48 : QUANTITY PER BOX / QUANTITY PER CASE. HINGES NOT SOLD INDIVIDUALLY.

P	26D	32D*
PRIME COATED	SATIN CHROME	SATIN STAINLESS STEEL

OTHER SIZES AND FINISHES AVAILABLE BY SPECIAL ORDER, PLEASE CONTACT FOR DETAILS.

(*) 304 STAINLESS STEEL, BB1099-4545 ONLY

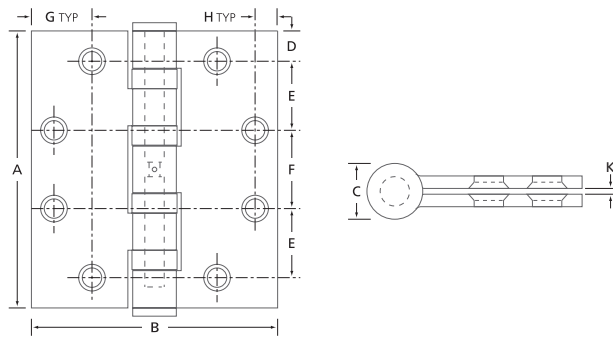

SIZE	A	B	C	D	E	F	G	H	K
4545	4½ (114.3)	4½ (114.3)	¾ (19)	½ (12.7)	1⅞ (28.6)	1⅞ ₆₄ (31)	1 (25.4)	¾ (9.5)	⅛ (1.8)
545	5 (127.0)	4½ (114.3)	¾ (19)	½ (12.7)	1⅞ (28.6)	1⅞ ₆₄ (31)	1 (25.4)	¾ (9.5)	⅛ (1.8)
55	5 (127.0)	5 (127.0)	¾ (19)	½ (12.7)	1¼ (31.8)	1⅞ ₃₂ (37.7)	1 (25.4)	¾ (9.5)	⅛ (1.8)

DIMENSIONS IN INCHES (MILLIMETRES) AS PER ANSI A156.7