

BOLTS & HASPS

GENERAL HARDWARE

MANUAL EXTENSION FLUSH BOLT – FIRE RATED

FBUL100



FBUL100-26D

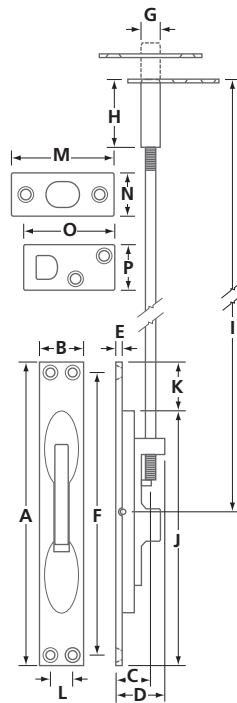

- UL listed for use with hollow metal, metal clad, steel covered composite, flush type sheet or metal swinging type fire doors.
- Not for wood fire doors
- Fits metal door preparation per ANSI A115.4-206
- Brass and steel components
- Throw: $\frac{3}{4}$ " (19 mm)
- Adjustable rod up to $\frac{7}{8}$ " (22.2 mm)
- Supplied with guide, strike plate and 12" (305 mm) $\frac{1}{4}$ -20 UNC threaded rod (see dimension "I")
- Mounting hardware included: combination machine-wood screws
- Optional rods available (not pictured):
 - #FBUL100R16 18" (457.2 mm) optional threaded rod
 - #FBUL100R22 24" (609.6 mm) optional threaded rod

MODEL	FINISH	A	B	C	D	E	F	G	H	I	J	K	L	M	N	O	P
FBUL100	-19, -26D, -3	$6\frac{3}{4}$ (171)	1 (25.4)	$\frac{3}{4}$ (19.1)	1 (25.4)	$\frac{1}{8}$ (3.2)	$6\frac{1}{4}$ (158.8)	$\frac{1}{2}$ (12.7)	$1\frac{1}{2}$ (38.1)	12 (305)	$4\frac{3}{4}$ (120)	1 (25.4)	$\frac{1}{2}$ (12.7)	$2\frac{1}{4}$ (57)	$1\frac{5}{16}$ (23.8)	2 (50.8)	1 (25.4)

IN (MM) 19: MATTE BLACK 26D: SATIN CHROME 3: POLISHED BRASS

BOLTS & HASPS

GENERAL HARDWARE

AUTOMATIC EXTENSION FLUSH BOLT

FB610M



FB610M-32D

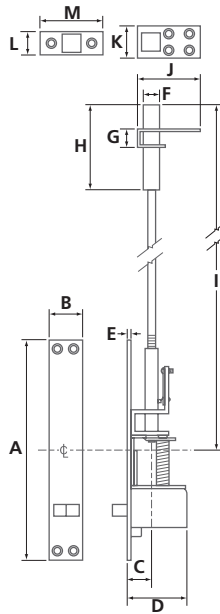

- UL labeled and rated only for hollow metal doors up to and including 3 hrs. Conforms to UL 10C and UBC 7-2-1997
- Top and bottom flush bolts for use on metal doors measuring up to 4 ft. (1219 mm) wide and 8 ft. (2438 mm) high
- Fits standard and ANSI preparation for metal doors
- Steel components
- Fully automatic, when active door is opened, inactive door is free
- Maintains inactive door locked in case of fire
- Supplied with bolt guide and door strike
- Mounting hardware included: machine and combination Machine-wood screws

MODEL	FINISH	A	B	C	D	E	F	G	H	I	J	K	L	M
FB610M	-32D	6 ³ / ₄ (171)	1 (25.4)	3/4 (19.1)	17/8 (47.6)	1/8 (3.2)	1/2 (12.7)	5/8 (15.9)	2 (50.8)	12 (305)	2 (50.8)	1 (25.4)	1 (25.4)	2 1/4 (57)

IN (MM) 32D: SATIN STAINLESS STEEL

BOLTS & HASPS

GENERAL HARDWARE

MANUAL EXTENSION FLUSH BOLT

DC860

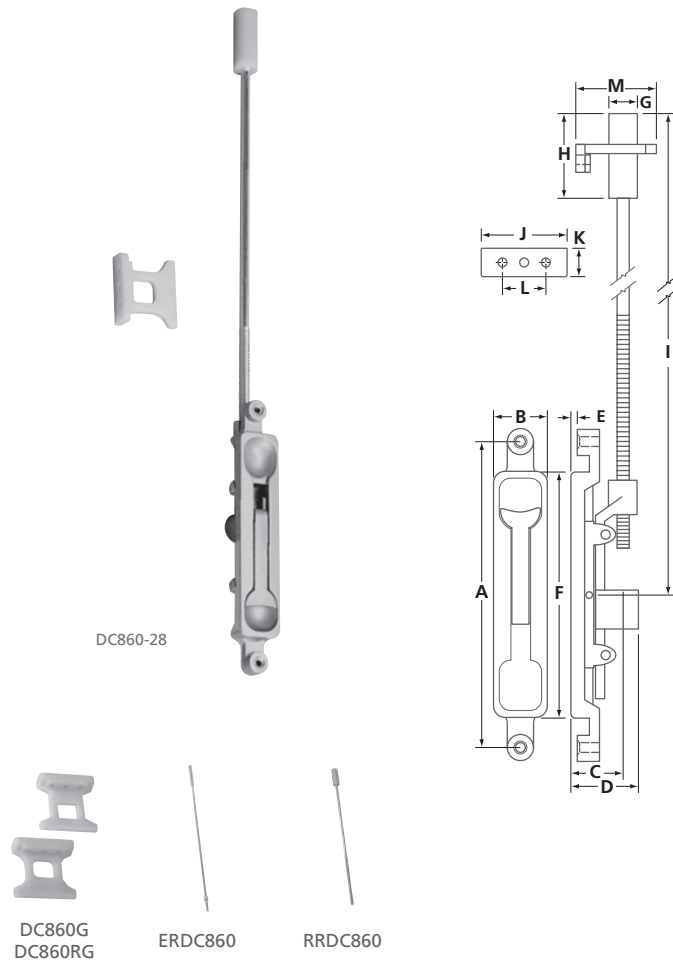

- Single bolt for aluminum doors
- 1/8" (3 mm)
- Throw: 3/8" (16 mm)
- Flush bolt faceplate with 5/32" (4 mm) radius corners
- Zinc die-cast and steel components
- Mounting hardware included: machine screws
- Supplied with threaded adaptor bushing and locking nuts
- Supplied with:
 - #RRDC860 12" (305 mm) Replacement rod
 - #ERDC860 12" (305 mm) 1/4-20 UNC extension rod
 - #DC860G / #DC860RG Nylon guides

MODEL	FINISH	A	B	C	D	E	F	G	H	I	J	K	L	M	/BOX
DC860	-15, -20D, -28	5/4 (133)	1 1/16 (23.8)	1 3/16 (20.6)	1 1/8 (28.6)	1/8 (3.2)	4 1/4 (108)	1/2 (12.7)	1 1/2 (38)	12 (305)	1 1/2 (38)	1/2 (12.7)	3/4 (19.1)	1 3/8 (34.9)	10

IN (MM) 15: SATIN NICKEL 20D: DARK BRONZE 28: ALUMINUM

BOLTS & HASPS

GENERAL HARDWARE

MANUAL EXTENSION FLUSH BOLT

DC840, 8402



DC840-15

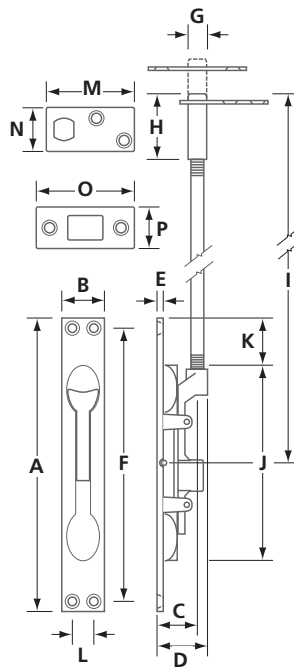

- Supplied with guide, strike plate and 12" (305mm) 1/16-18 UNC threaded rod
- Fits metal door preparation per ANSI A115.4-1981
- Zinc-diecast and steel components
- Mounting hardware included: machine and wood screws

#DC840 has a 5/8" (15.9mm) throw and +5/8" (15.9mm) adjustment

#8402 has a 1/2" (12.7mm) throw and ±1/4" (6.4mm) adjustment

MODEL	FINISH	A	B	C	D	E	F	G	H	I	J	K	L	M	N	O	P	/UNIT
DC840	15	6 3/4 (171)	1 (25.4)	3/4 (19.1)	1 (25.4)	9/64 (3.6)	6 1/4 (158.8)	7/16 (11.1)	1 1/2 (38.1)	12 (305)	4 3/4 (111)	1 (25.4)	1/2 (12.7)	2 (50.8)	1 5/16 (23.8)	2 1/4 (57)	1 5/16 (23.8)	2
8402	26D	6 3/4 (171)	1 (25.4)	3/4 (19.1)	1 (25.4)	9/64 (3.6)	6 1/4 (158.8)	1/2 (12.7)	1 1/2 (38.1)	12 (305)	4 9/16 (116)	1 (25.4)	1/2 (12.7)	2 (50.8)	1 5/16 (23.8)	2 1/4 (57)	1 5/16 (23.8)	2

IN (MM) 15: SATIN NICKEL 26D: SATIN CHROME